

# 7" Twin JBT Jumbo Tissue Dispenser

**Double coverage to eliminate run-outs, prevent waste and save labor by using one roll up before transferring to the second**

## KEY OPERATING FEATURES

- Sequential Use:** Auto transfer
- Orientation:** Lateral
- Spindle Function:** Fixed, rotating without knob, or rotating with knob
- Spindle Type:** Universal or proprietary

## PAPER SIZE

- Type:** Jumbo roll
- Diameter:** 7.0" (178mm)
- Core:** 1.5" to 3.3" (38mm to 84mm)

## CONSTRUCTION

- Roll Capacity:** 2 rolls
- Material:** Tough, easy to clean industrial plastic
- Locks:** Generic, fixed or proprietary key available

## ADDITIONAL FEATURE

- User friendly, continuous flow technology
- Complete consumption of first roll before accessing second—eliminates stub roll waste
- Easy paper loading saves labor



**JT207-00  
White**



**JT207-00  
Smoke**

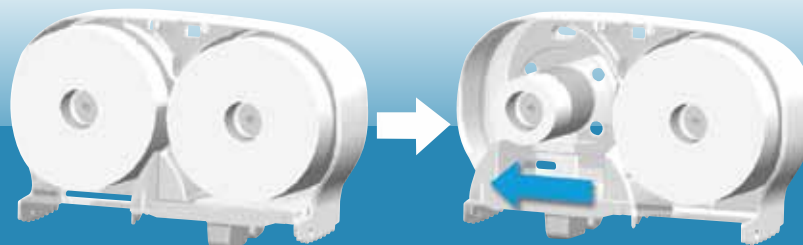

*Auto transfer system ensures complete consumption of first roll before accessing second*

**JT207-00**

# 7" Twin JBT Jumbo Tissue Dispenser

Double coverage to eliminate run-outs, prevent waste and save labor by using one roll up before transferring to the second

## Dispenser Specifications:

Finish/Color: White cover and back housing  
Transparent smoke gray cover and light gray back housing

### Dispenser Dimensions

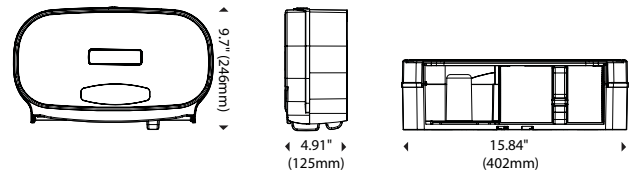

## Paper Specifications:

Paper Capacity: 2 rolls  
Roll Width: 4.0" (102mm) max  
Roll Diameter: 7.0" (178mm) max  
Core Size: 1.5" to 3.3" (38mm to 84mm)

### Roll Dimensions

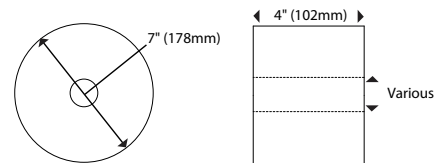

## Shipping Specifications:

Weight in Case: 3.0 lbs (1.4kg)  
Case Dimensions (L x W x H): 16 5/16" x 6 1/16" x 10 1/2" (414mm x 153mm x 267mm)  
Units per Case: 1  
**North America**  
Cases/Pallet\*: 204  
Weight/Pallet\*: 657.0 lbs (298.0kg)  
**International:**  
Cases/Pallet\*: 195  
Weight/Pallet\*: 630.0 lbs (285.8kg)  
SKU: **JT207-00**  
(replaces JT207-02)

### Shipping Configurations

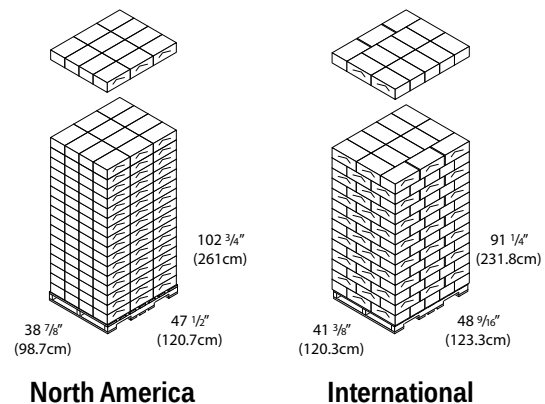

### Dispensing solutions to grow your business!

We offer the widest array of options in the industry, customizing solutions to give you the functional capabilities, proprietary lock-outs features, and aesthetic choices you need to support your business strategy.

**Start dispensing value today!**  
[www.DispensingDynamics.com](http://www.DispensingDynamics.com)



**Corporate Headquarters**  
1020 Bixby Drive  
City of Industry, CA 91745  
U.S.A.  
**(1) 800-888-3698**

**International Sales Office**  
19440 Enterprise Way  
Surrey, BC V3S 6J9  
Canada  
**(1) 888-225-7380**

