

9" Twin JBT Jumbo Tissue Dispenser

Double coverage to eliminate run-outs, prevent waste and save labor by using one roll up before transferring to the second



JT209-05
White

KEY OPERATING FEATURES

Sequential Use:	Auto transfer
Orientation:	Lateral
Spindle Function:	Fixed
Spindle Type:	Universal or proprietary

PAPER SIZE

Type:	Jumbo roll
Diameter:	9.0" (229mm)
Core:	1.5" to 3.3" (38mm to 84mm)

CONSTRUCTION

Roll Capacity:	2 rolls
Material:	Tough, easy to clean industrial plastic
Locks:	Generic, fixed or proprietary key available



JT209-05
Black

ADDITIONAL FEATURES

- User friendly continuous flow technology
- Complete consumption of first roll before accessing second—eliminates stub roll waste
- Easy paper loading saves labor

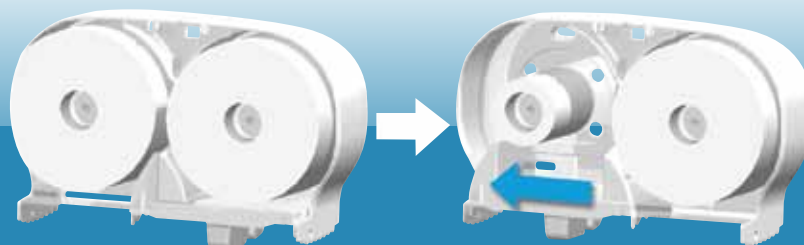

Auto transfer system ensures complete consumption of first roll before accessing second

JT209-05

9" Twin JBT Jumbo Tissue Dispenser

Double coverage to eliminate run-outs, prevent waste and save labor by using one roll up before transferring to the second

Dispenser Specifications:

Finish/Color: White cover and back housing
Black cover and back housing

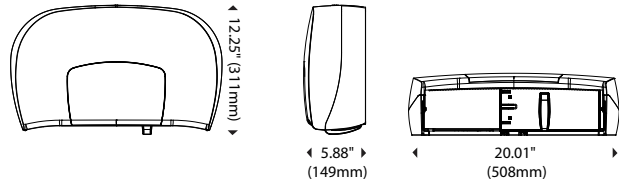

Dispenser Dimensions

Paper Specifications:

Paper Capacity: 2 rolls
Roll Width: 4.0" (102mm)
Roll Diameter: 9.0" (229mm)
Core Size: Roll holders of various sizes, and proprietary options, are available

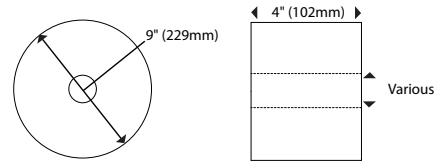

Roll Dimensions

Shipping Specifications:

Weight in Case: 4.2 lbs (1.9kg)
Case Dimensions (L x W x H): 20 1/4" x 5 15/16" x 12 3/4" (514mm x 151mm x 324mm)

Units per Case: 1

North America

Cases/Pallet*: 112
Weight/Pallet*: 515.4 lbs (233.8kg)

International:

Cases/Pallet*: 112
Weight/Pallet*: 515.4 lbs (233.8kg)

SKU: **JT209-05**

*Subject to change to maximize container load

Shipping Configurations

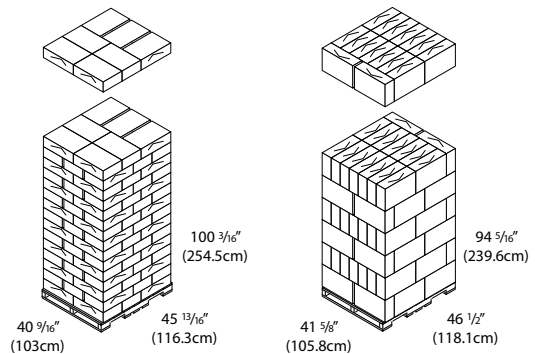

North America

International

Dispensing solutions to grow your business!

We offer the widest array of options in the industry, customizing solutions to give you the functional capabilities, proprietary lock-outs features, and aesthetic choices you need to support your business strategy.

Start dispensing value today!
www.DispensingDynamics.com



Corporate Headquarters
1020 Bixby Drive
City of Industry, CA 91745
U.S.A.
(1) 800-888-3698

International Sales Office
19440 Enterprise Way
Surrey, BC V3S 6J9
Canada
(1) 888-225-7380

